



Saturday Morning Injury Clinic

At Lee's Summit Medical Center Outpatient Therapy Services Clinic (in the Medical Office Building)
 2100 SE Blue Parkway
 Lee's Summit, MO 64063

8:00 – 10:00 A.M. EVERY SATURDAY
STARTING AUGUST 20TH THROUGH THE END OF FALL SPORTS

Lee's Summit Sports Medicine is offering a free sports injury clinic for athletes every Saturday morning. The Saturday Morning Injury Clinic is open to **ALL fall sports' athletes** in the area, *regardless of school affiliation*.

The initial consultation/evaluation and any emergent/acute injury treatments by a Certified Athletic Trainer/Physician that are provided that morning are **FREE**.

You may receive a referral for additional testing (X-ray/MRI/etc.) or consult to specialist or prescription for rehabilitation. If a referral is made, you will be given the choice of where to follow up and your insurance will be billed for those fees generated by the referral.

DUE TO FEDERAL LAWS AND REGULATIONS, PHYSICAL THERAPY TREATMENTS CANNOT BE RENDERED FOR FREE DURING SATURDAY MORNING INJURY CLINIC.

Also, for legal reasons, ***if the athlete is under the age of 18, we require that a parent or guardian accompany them.*** We will not perform any actions that would generate a charge without first talking to the parent or guardian. A form will be sent home to the parents and the coach/athletic trainer to inform them of the physician's diagnosis and follow up care recommended.

We request athletes arrive no later than 9:00 AM. WE WILL EVALUATE EVERYONE THAT IS REGISTERED BY 9:00 AM.

****Please bring photo identification and insurance information just in case an x-ray is needed, etc.**

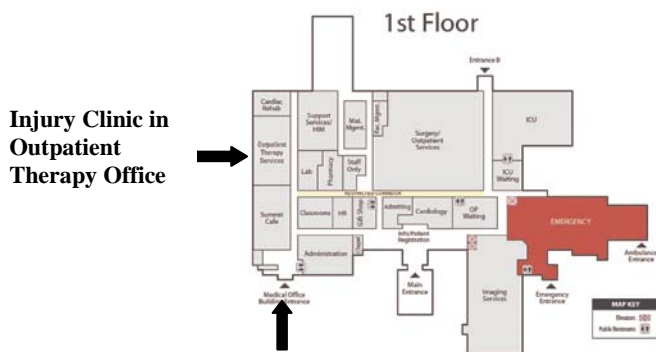

Enter Through Medical Office Entrance

